

## XPi Bent Axis Piston Pumps

### How to change the rotation of a Harsh Piston Pump,

With suction fitting

All Harsh Piston pumps are supplied for Clockwise rotation (CW) unless other specified on each purchase order.

To check which direction the pump should rotate on your installation;

- Check the direction of rotation of the PTO;
- If the PTO turns clockwise, the pump must rotate counter clockwise, and vice versa.

To change the direction of rotation of your XP pump;

- Remove the inlet fitting (2) and the 2 parts of the split flange (3).
- Remove the rotation setting screw (1).
- Remove the plug (6).
- Put the rotation setting screw (1) where plug (6) was and the plug (6) where rotation setting screw (1) was.
- Put seal (5) on the inlet fitting, then the inlet fitting on the side where plug (6), and fix with the split flange. Tighten with screws (4).

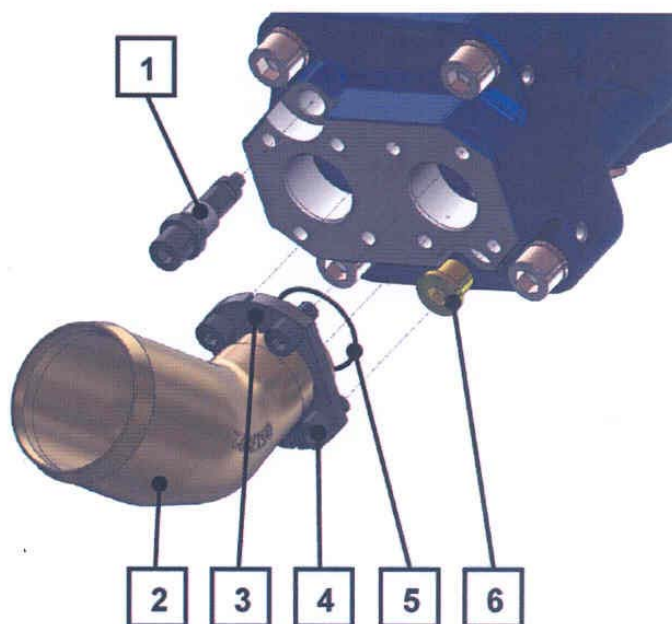

#### IMPORTANT NOTE:

Do not rotate pump shaft at all until the rotation setting screw (1) is in place. The rotation setting screw is always on the output (pressure) side.

The various parts should be tightened to the following torque values;

- Tightening torque of rotation setting screw (1) in m.daN 4
- Tightening torque of fixation screws (4) in m.daN 2.5
- Tightening torque of plug (6) in m.daN 2.5

